



## SynScan "V4" Versus Previous SynScan "V3" GoTo Hand Controller

Starting around April of 2014 the long-standing "V3" version of the SynScan hand controller was phased out and the new "V4" SynScan was released. The V4 is now the version of the SynScan controller that is included with new production units of Orion's GoTo telescopes and mounts.

The V4 looks a little different from the V3 – the V4 is longer and a little thicker, has a couple of small "ears" on each side near the top, and has no DC input port on the bottom end like the V3 had. But functionally the V4 is pretty much the same as the V3. The reason for the change was that some components included in the manufacture of the V3 were discontinued and unable to be acquired, forcing a slight re-design with newly sourced components.

### Here are a few more important things to know about the V4 vis-à-vis the V3:

1. The V4 and V3 are interchangeable on any Orion GoTo telescope or mount that uses the SynScan hand controller.
2. The V4 hand controller's firmware is different from that for the V3; the firmware is not currently cross-compatible between

the two models. We will provide firmware updates for both the V3 and V4 controllers in the future, as need arises.

**Be sure to choose the correct firmware loader and file for your version of the SynScan controller! Firmware and loader files for the V4 will have "V4" in the filename.**

3. If you have a SynScan V3 controller, there is no reason to "upgrade" to the V4, because it is not considered an upgrade. (See second paragraph, above.) However, if you need to replace your V3 controller due to loss or breakage, your only option will be to get the V4 since the V3 is no longer available.
4. Unlike the V3, the SynScan V4 has no DC power input port, so it cannot be powered on independently from the mount for firmware updates or for scanning the menus in "PC Direct" mode. Instead, you must connect the hand controller to the mount with the coiled hand controller cable and then power on the mount using an appropriate 12V DC or AC-to-12V DC power supply.
5. The SynScan instruction manual has been revised for the V4.

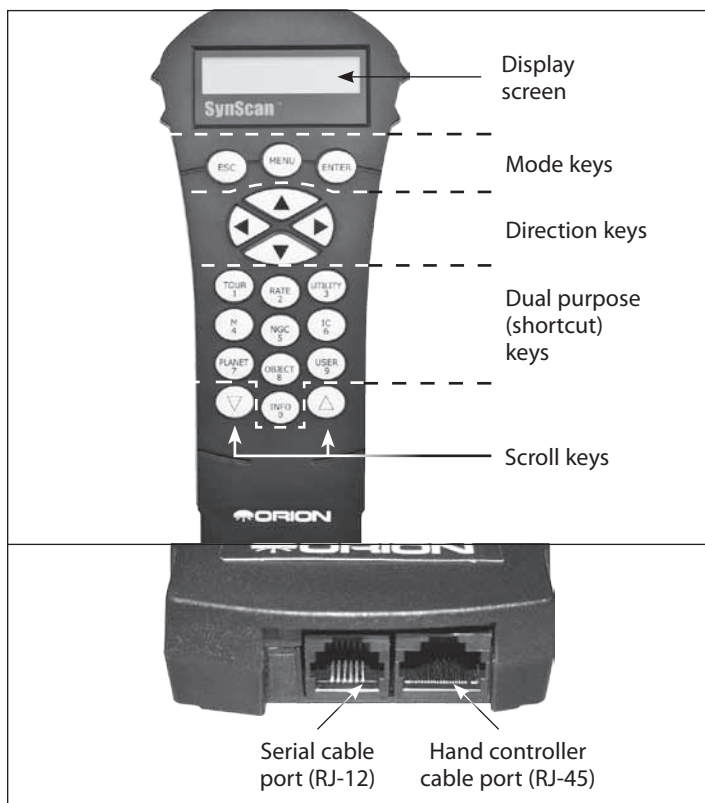

SynScan V4 Controller

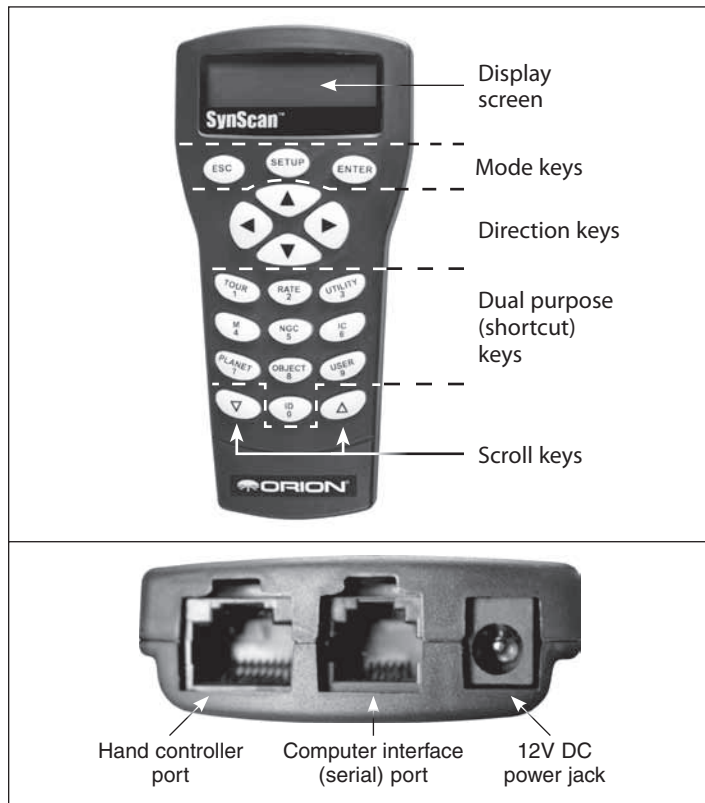

SynScan V3 Controller (discontinued)